

CABIN LAYOUTS AND ASSIGNMENTS

****Please verify which campsite you are assigned to as each campsite has a slightly different layout****

Camp Allen recommends at least 1 chaperone in each cabin for students in 8th grade or below. Schools are at their own discretion for exact requirements. Contact us if you have any questions or concerns.

Campsites 1 and 2—8 “tree house” style cabins that sleep 10 people. The “DQ” (adult area) has 2 private bathrooms and 4 bedrooms with 3 beds in each room.

Cabins 4, 8 (Campsite 1) and 11, 16 (campsite 2) are ground level handicap cabins

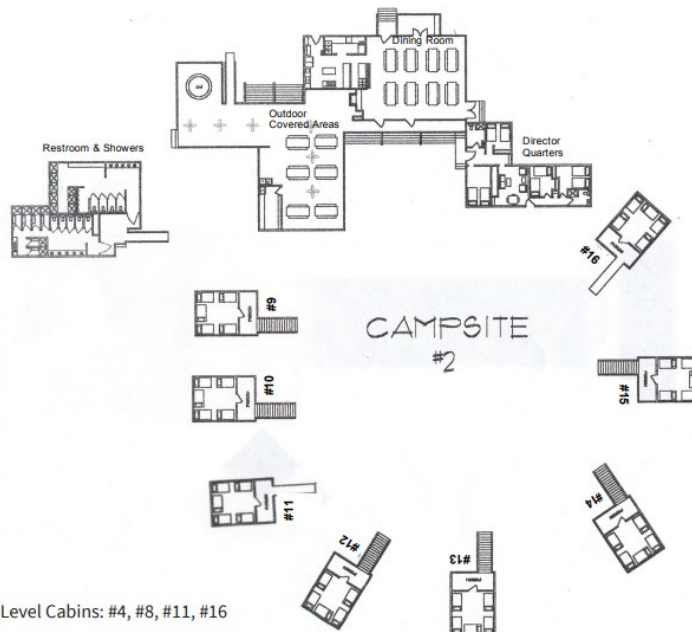
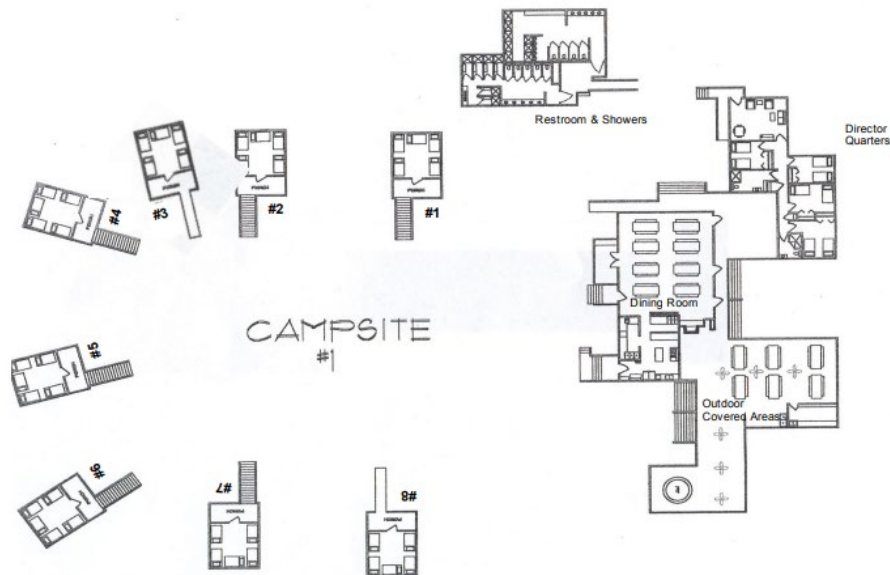

Ground Level Cabins: #4, #8, #11, #16

Campsite 3 A and B—Campsite 3 is divided into 2 identical buildings, A and B. Each building has 4 cabins that each sleeps 14 people. If your group is large enough to need more than 2 cabins for each gender, schools usually separate the girls in 3A and the boys in 3B. Cabins 19 and 24 are the “DQ” adult areas in this campsite that each sleep 6 with a private bathroom.

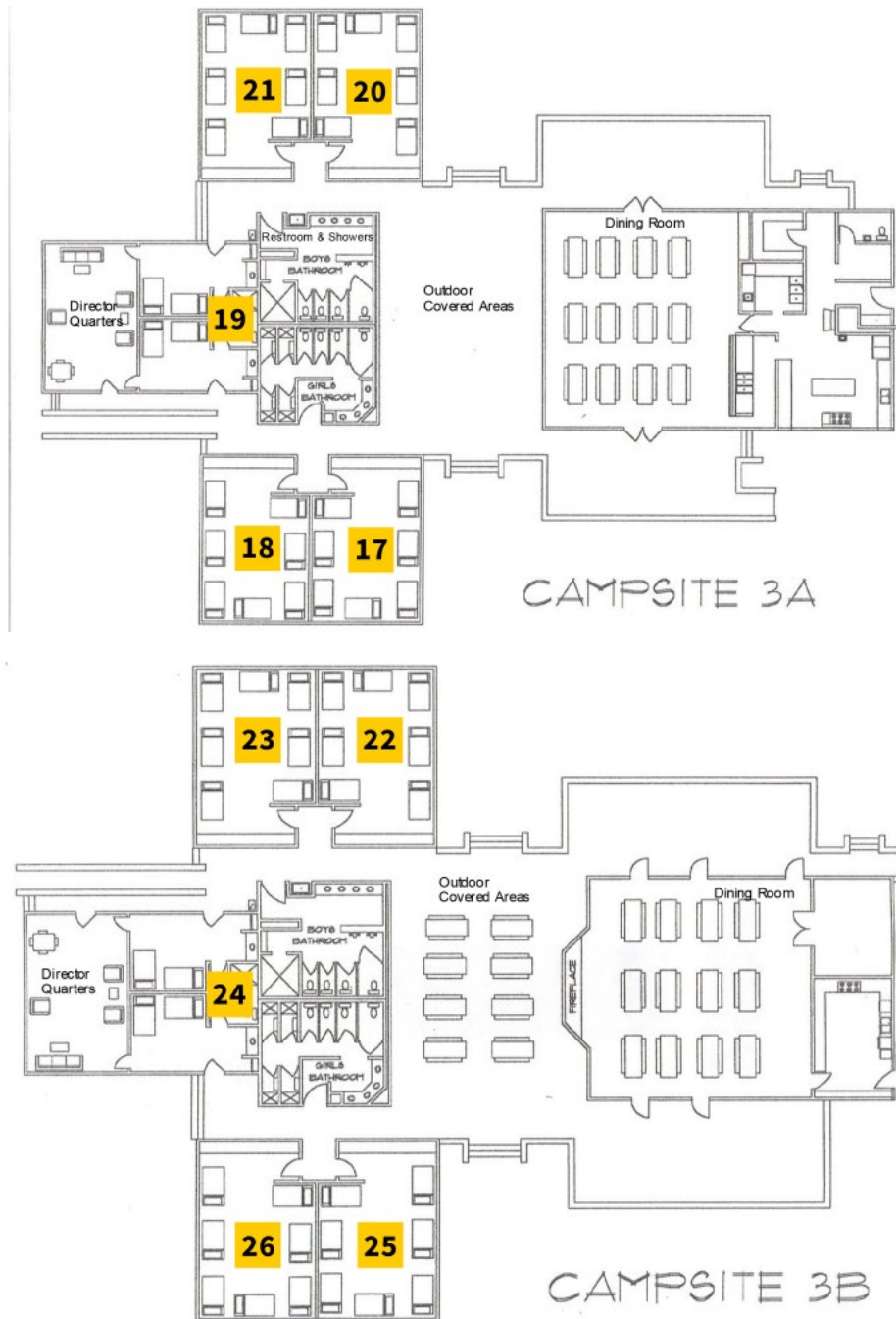

Campsite 4 is divided between 4 bunk houses that each have 2 cabins in them and share a bathroom. For this reason, both cabins in the bunk house should be the same gender. There is a sliding door that connects the 2 cabins that can be kept open if needed for supervision purposes. Each cabin contains 12 beds. The adult area “Leader’s Quarters” has 4 bedrooms with 4 beds and a private bathroom with showers in each.

CAMPSITE 4 & THE BISHOP DOYLE CENTER LAYOUT

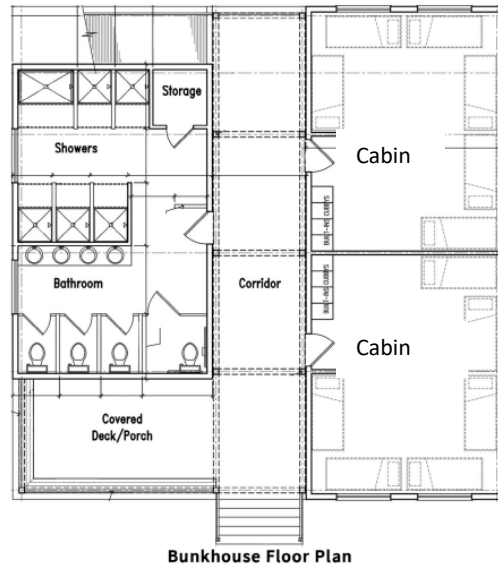
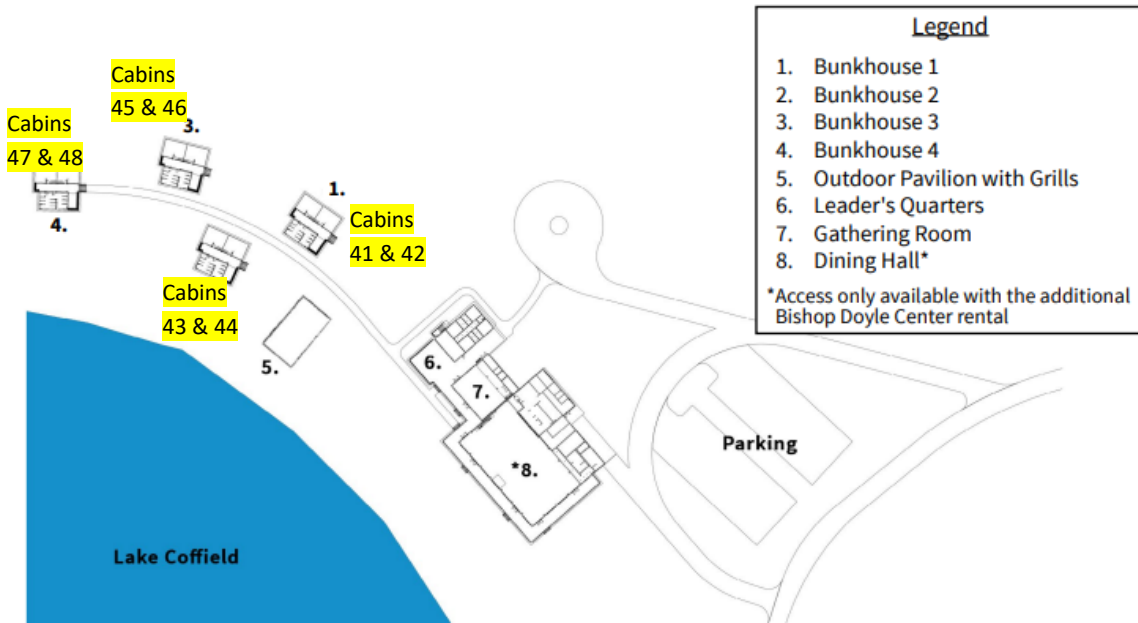

FEMALE CABIN ASSIGNMENTS

Cabin # _____

1. _____

2. _____

3. _____

4. _____

5. _____

6. _____

7. _____

8. _____

9. _____

10. _____ (campsite 3 & 4 only)

11. _____ (campsite 3 & 4 only)

12. _____ (campsite 3 only)

13. _____ (campsite 3 only)

ADULT FEMALE(S): _____

9 kids per cabin with one adult in campsites 1 and 2. 13 kids per cabin with one adult in campsite 3. 11 kids per cabin with one adult in campsite 4



MALE CABIN ASSIGNMENTS

Cabin # _____

1. _____

2. _____

3. _____

4. _____

5. _____

6. _____

7. _____

8. _____

9. _____

10. _____ (campsite 3 & 4 only)

11. _____ (campsite 3 & 4 only)

12. _____ (campsite 3 only)

13. _____ (campsite 3 only)

ADULT MALE: _____

9 kids per cabin with one adult in campsites 1 and 2. 13 kids per cabin with one adult in campsite 3. 11 kids per cabin with one adult in campsite 4

